

# Bookeye® 3

A1 Book Scanners



High quality production systems

Made in Germany



The principle of scanning historic books, valuable manuscripts, stapled documents, color drawings and maps without causing damage has been optimised and refined with the new generation of **Bookeye®** overhead scanners.

The scanner developed and produced in Germany combines state of the art scanning lenses, high-quality CCD image sensors and white LED light, bundled in a movable continuous light strip, which follows the scanning process.

**Bookeye® 3** meets individual requirements. This scanning resolution equips you to digitise many different types of originals. **Bookeye® 3** is available either as color or as grayscale unit.





Integrated book cradle

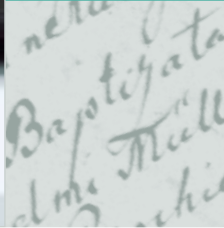

## FEATURES

- oversize originals larger than A1 format
  - precise LINOS Rodenstock scanning lens
  - high-resolution CCD image sensors
  - autofocus / automatic format recognition
  - focused, glare-free continuous light strip due to High Power White LED during the scanning process
  - 100 % UV- and IR-free light
  - ergonomic optimisation due to dimmable lamps
  - service life of lamp over 20,000 hours
  - integrated motorised book cradle with 100 mm lift
  - variable adjustment to width of spine
  - wooden contact surface for scanning without damage to original
  - optional glass plate
- BCS-2<sup>®</sup> capturing software with the following functions:
    - page separation
    - indexing
    - masking, multi masking
    - cutting
    - deskew / despeckle
    - bookfold correction
    - e-mail connection
    - PDF; PDF/A conversion
    - Web publishing
    - OCR
    - WalkUp Emulator
  - output formats:
    - TIFF G4, JPEG, PNG, TIFF, PDF, PDF/A, multipage TIFF, Zip, PCX, BMP, GIF
    - output of metadata in XML, CSV
    - all formats can be stored simultaneously



Additional book holder



Bookeye<sup>®</sup> 3 with Mando furniture

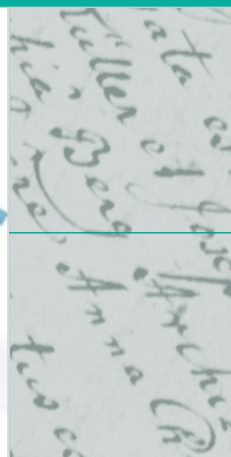
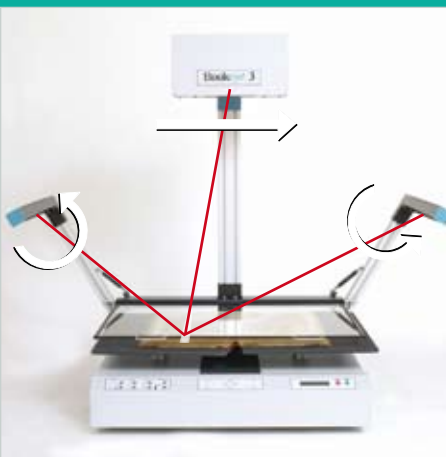

LED lamps

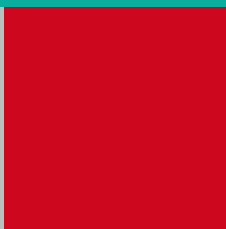
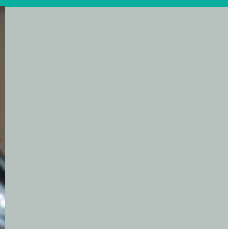

Rotating lamps synchronised with the camera

## TECHNICAL DATA

Product	Article number
Bookeye® 3 A1 GS (grayscale)	BE3-SYSGS-R1
Bookeye® 3 A1 Color	BE3-SYSCL-R1
<b>Device data</b>	
dimensions in H x W x D in mm	1,200 x 1,460 x 770 (with lamp arms)
	1,200 x 900 x 770 (without lamp arms)
weight without packaging in kg	approx. 60
electrical connection	
<ul style="list-style-type: none"> <li>voltage</li> </ul>	100-240 V
<ul style="list-style-type: none"> <li>frequency</li> </ul>	50-60 Hz
<ul style="list-style-type: none"> <li>output</li> </ul>	50 VA standby / 150 VA operating
<ul style="list-style-type: none"> <li>lamps</li> </ul>	LUXEON white LED approx. 5,000 LUX continuous light strip
<b>Format of originals</b>	
maximum W x D in mm	900 x 635
	(> A1)
<b>Scanning</b>	
resolution in dpi	200, 300, <b>400</b> , 600
scanning time in sec	10 for A1 format
color depth for Color (internal / external)	36 bit / 24 bit
color depth for GS (internal / external)	1,024 / 256 grayscales
interface/protocol	1,000 MBit network / TCP/IP
software	BCS-2*
<b>Accessories</b>	
	<b>Article number</b>
glass plate	BE3-BC-A1KA
additional keyboard	BE-KB-001
foot switch	BE-FS-01
copy card reader	on request
book holder	BE3-BC-RL/BE3-BC-VO
Mando furniture	MADR-BI-RAL-9006



## HIGHLIGHTS

- A1 oversize
- high resolution (300 x 400 dpi)
- rapid scanning
- integrated book cradle
- LED lamps
- laser-assisted profile detection
- 1 GBit network interface (TCP/IP)
- easy to use

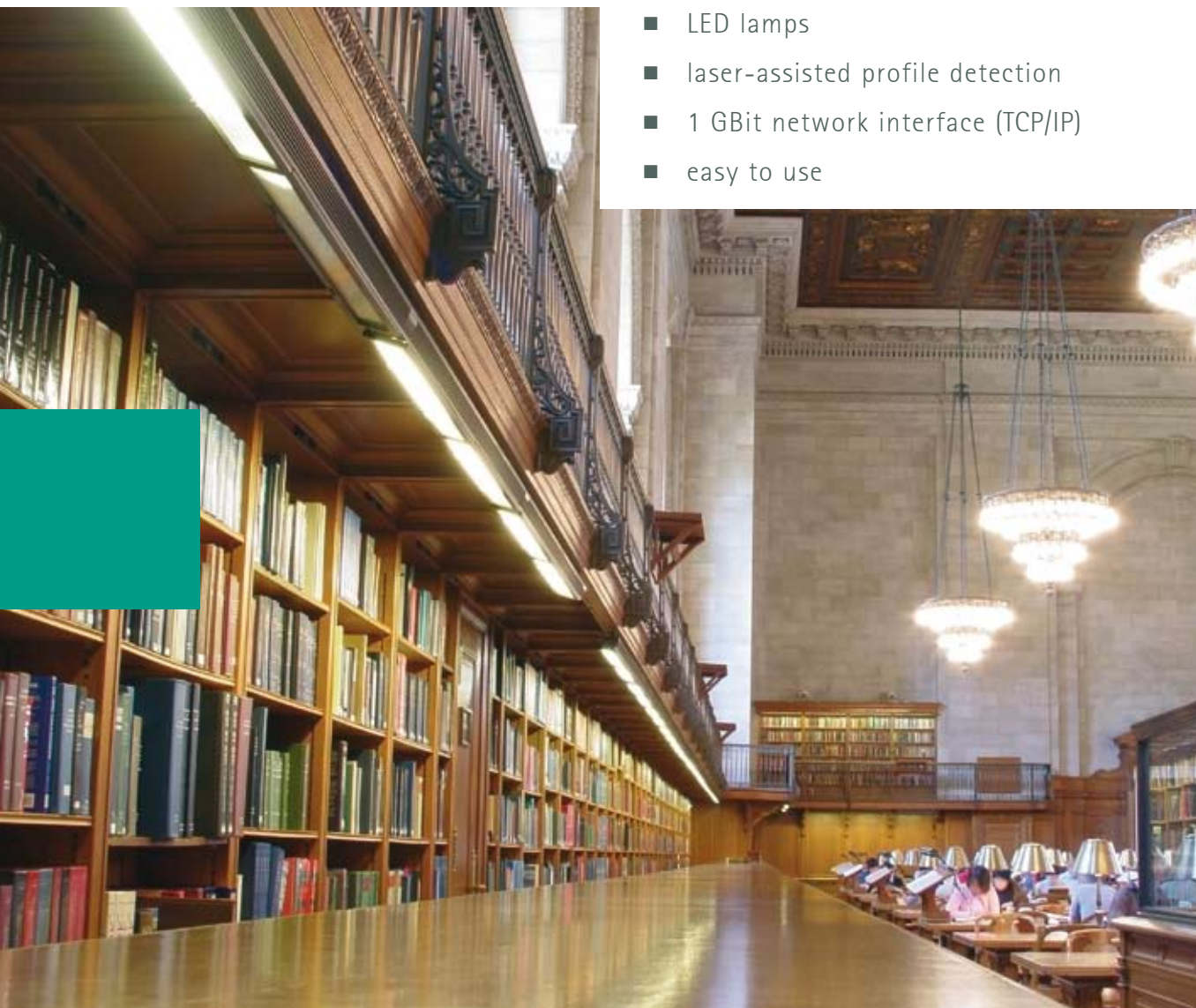

aptes  
ebenen  
mit Sa  
g also  
tag dage  
tag dage  
also der  
Tag (Sa  
ür

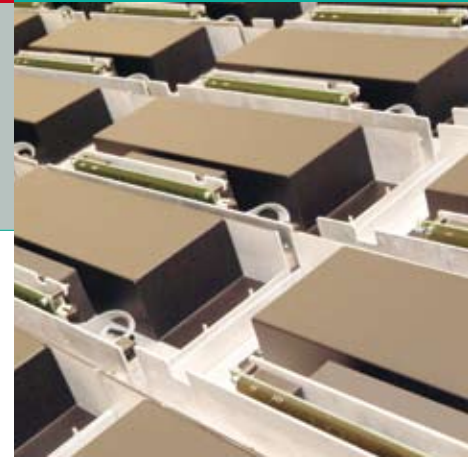
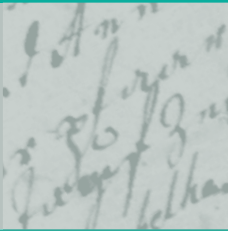

glass plate

BCS-2®



book holder (right/left)

MyBib eDoc®



additional keyboard



book holder (front)

Bookeye®



Mando furniture

C-3



ImageWare

ImageWare Components GmbH  
Am Hofgarten 20

53113 Bonn  
Germany

Tel.: + 49 - 228 / 969 85 - 0  
Fax: + 49 - 228 / 969 85 - 84

E-Mail: [bookeye@imageware.de](mailto:bookeye@imageware.de)  
[www.bookeye.com](http://www.bookeye.com)